

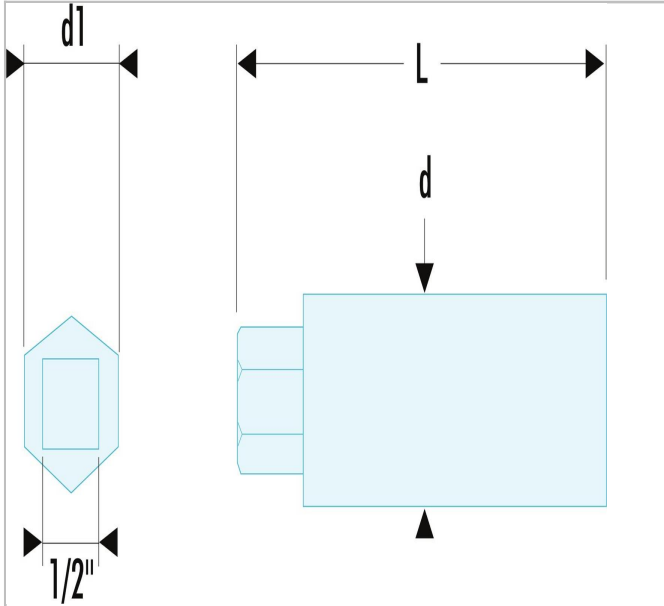

287B.9 | 287B - Roller-type stud drivers - Single-diameter



Description:

- Capacity: Ø 6 to 16 mm.
- Turned by means of the hexagonal drive or a 1/2" - 12.7 mm ratchet.
- Except model 287B.16, which has a through-hole for a bar.
- Allows to tighten or untighten the studs.



 287B.9	
Length L [mm]	75.0
Diameter D1 [mm]	22.0
Weight [g]	245.0
Diameter [mm]	29.0
Hex Size [mm]	22.0
A Maxi [mm]	9.0